

# ESZ-26B

Features : \* Continuous/pulse selectable sound

\* Due to contactless construction, this buzzer is almost free from noise generation and has a durable life.

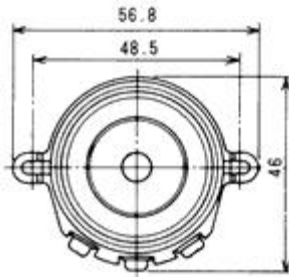

When mounting bracket are not required in the installation, it can be cut off easily from the housing.

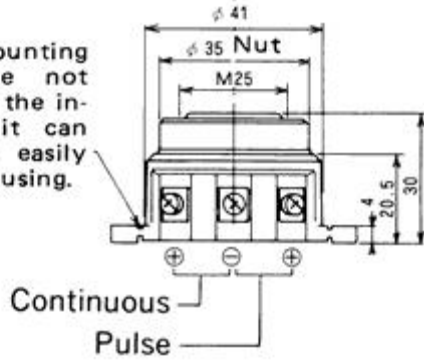

Model	Power supply	Rated voltage [V]	Current Consumption [mA]	Sound Output [dB (A)/10cm]	Operating Voltage range [V]	Operating Temperature range [°c]	Intermittent Rate [Times/5 sec]	Terminal	Case color
ESZ-26B	DC	24	16	107	3~28	-20~+60	4~7	Screw	Black